



Scientific Microwave

AN ISO 9001-2008 CERTIFIED COMPANY

Manufacturers of: Microwave Passive Components
Instruments & custom made Components etc.

GST NO – 09AXAPS2587H1Z2

DATA SHEET

DESCRIPTION – WAVEGUIDE TO N TYPE ADAPTER (WR137)

PART NO – SM018W137N-M38

REF BEL PART NO – 455043820188

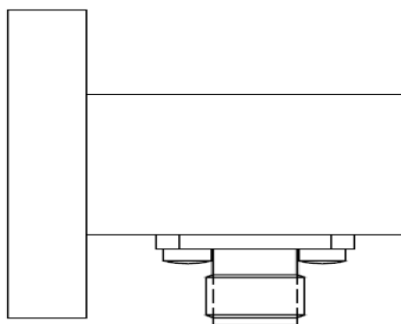

ELECTRICAL SPECIFICATION –

1. FREQUENCY RANGE – 5.85 to 8.2 GHz
2. VSWR – 1.25 (Max.)
3. INSERTION LOSS – 0.1dB
4. CONNECTOR – N (Male)

MECHANICAL SPECIFICATION –

1. WAVEGUIDE SIZE – WR137
2. MATERIAL – BRASS/COPPER
3. PRESSURE – 10Psi
4. FINISH – CORROSION TREATMENT

ADDRESS: - PLOT NO 31, LANE NO-4, RAJENDER NAGAR INDL AREA MOHAN NAGAR GHAZIABAD – 201007 U.P.

E-mail: - info@smwave.com, scientificmicrowaves@gmail.com

WEB SITE: - www.smwave.com